

2024 STREET RESURFACING PROGRAM

VILLAGE OF MOUNT PROSPECT, COOK COUNTY

LOCATION MAP

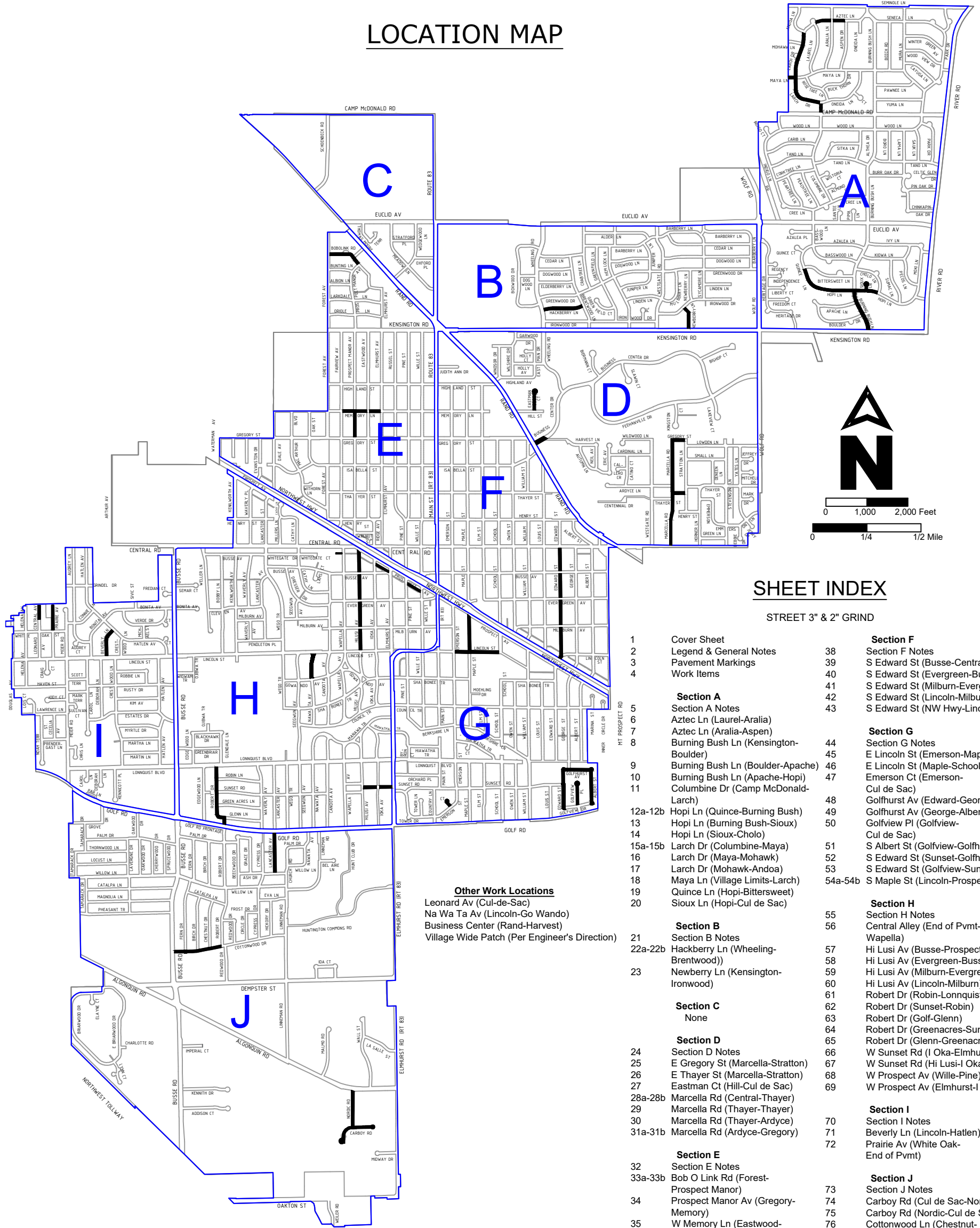

SHEET INDEX

STREET 3" & 2" GRIND

1	Cover Sheet		
2	Legend & General Notes	38	Section F
3	Pavement Markings	39	Section F Notes
4	Work Items	40	S Edward St (Busse-Central)
		41	S Edward St (Evergreen-Busse)
		42	S Edward St (Milburn-Evergreen)
		43	S Edward St (Lincoln-Milburn)
		43	S Edward St (NW Hwy-Lincoln)
	Section A		
5	Section A Notes		Section G
6	Aztec Ln (Laurel-Aralia)	44	Section G Notes
7	Aztec Ln (Aralia-Aspen)	45	E Lincoln St (Emerson-Maple)
8	Burning Bush Ln (Kensington-Boulder)	46	E Lincoln St (Maple-School)
9	Burning Bush Ln (Boulder-Apache)	47	Emerson Ct (Emerson-Cul de Sac)
10	Burning Bush Ln (Apache-Hopi)	48	Golfhurst Av (Edward-George)
11	Columbine Dr (Camp McDonald-Larch)	49	Golfhurst Av (George-Albert)
12a-12b	Hopi Ln (Quince-Burning Bush)	50	Golfview Pl (Golfview-Cul de Sac)
13	Hopi Ln (Burning Bush-Sioux)	51	S Albert St (Golfview-Golfhurst)
14	Hopi Ln (Sioux-Cholo)	52	S Edward St (Sunset-Golfhurst)
15a-15b	Larch Dr (Columbine-Maya)	53	S Edward St (Golfview-Sunset)
16	Larch Dr (Maya-Mohawk)	54a-54b	S Maple St (Lincoln-Prospect)
17	Larch Dr (Mohawk-Andoa)		
18	Maya Ln (Village Limits-Larch)		Section H
19	Quince Ln (Hopi-Bittersweet)	55	Section H Notes
20	Sioux Ln (Hopi-Cul de Sac)	56	Central Alley (End of Pvmt-Wapella)
		57	Hi Lusi Av (Busse-Prospect)
		58	Hi Lusi Av (Evergreen-Busse)
		59	Hi Lusi Av (Milburn-Evergreen)
		60	Hi Lusi Av (Lincoln-Milburn)
		61	Robert Dr (Robin-Lonnquist)
		62	Robert Dr (Sunset-Robin)
		63	Robert Dr (Golf-Glenn)
		64	Robert Dr (Greenacres-Sunset)
		65	Robert Dr (Glenn-Greenacres)
		66	W Sunset Rd (I Oka-Elmhurst)
		67	W Sunset Rd (Hi Lusi-I Oka)
		68	W Prospect Av (Wille-Pine)
		69	W Prospect Av (Elmhurst-I Oka)
			Section I
		70	Section I Notes
		71	Beverly Ln (Lincoln-Hatlen)
		72	Prairie Av (White Oak-End of Pvmt)
			Section J
		73	Section J Notes
		74	Carboy Rd (Cul de Sac-Nordic)
		75	Carboy Rd (Nordic-Cul de Sac)
		76	Cottonwood Ln (Chestnut-Robert)
		77	Cottonwood Ln (Birch-Chestnut)
		78	Cottonwood Ln (Fern-Birch)
		79	Cottonwood Ln (Busse-Fern)
		80	Nordic Rd (Carboy-Algonquin)
		81a-81b	S Lancaster Av (Ash-Golf)

Other Work Locations
 Leonard Av (Cul-de-Sac)
 Na Wa Ta Av (Lincoln-Go Wando)
 Business Center (Rand-Harvest)
 Village Wide Patch (Per Engineer's Direction)

VILLAGE OF MOUNT PROSPECT
PUBLIC WORKS DEPARTMENT
 1700 W CENTRAL ROAD
 MOUNT PROSPECT, IL 60056
 T 847.870.5640 | F 847.253.9377

DIRECTOR OF PUBLIC WORKS: SEAN DORSEY
VILLAGE ENGINEER: MATT LAWRIE, P.E.
PROJECT ENGINEER: MARK LATTNER, P.E.
CIVIL ENGINEER: JACOB OLP

Project Website:
www.mountprospect.org/resurfacing



- FAQs
- Contacts
- More Information

X (Twitter) Daily Updates:
@MP_Resurfacing

- Up-to-date Activities
- Changes in Schedule
- Construction Progress



FOLLOW US ON TWITTER DURING THE CONSTRUCTION SEASON TO STAY INFORMED ON UPCOMING WORK



VILLAGE OF
MOUNT PROSPECT

PUBLIC WORKS DEPARTMENT • **ENGINEERING DIVISION**

2024 STREET RESURFACING PROGRAM

DESIGNED: ML
 APPROVED: ML

COVER SHEET
 LOCATION MAP AND INDEX
 DATE: 01.01.24
 PAGE: 1 OF 81
 SHEET: 1