

# OVERHEAD SEWER REBATE PROGRAM

## OVERVIEW

The Village of Mount Prospect has established the Overhead Sewer Rebate Program. The program will provide financial assistance to residents who want to convert their existing gravity-fed sanitary system into an overhead sanitary sewer system (see exhibit on back). Note: This program does not cover an alternate flood control system or solutions for overland stormwater flooding.

To take advantage of the program, homeowners will need to:

- **Apply for the program (Pre-Approval Required)**
- Apply and obtain permits
- Obtain all required Village inspections during construction
- Apply for the Rebate Request after final inspection

To be eligible for the program:

- The homeowner must be a Village water utility consumer.
- The perimeter drain tile and any other stormwater source must be disconnected from the Village's sanitary or combined sewer.
- Installation of a sump pit and sump pump is required.
- The sump pump is to discharge the stormwater onto the ground in the property's front or rear. This requirement is not applicable if a proper sump pit for perimeter drain tile already exists.

For technical questions regarding installation, please contact our Plumbing Inspector at (847) 870-5675.

For administrative questions, call the Public Works Department at (847) 870-5640.

For more information and an application, visit [www.mountprospect.org/overheadsewerrebate](http://www.mountprospect.org/overheadsewerrebate).



# OVERVIEW DRAWING

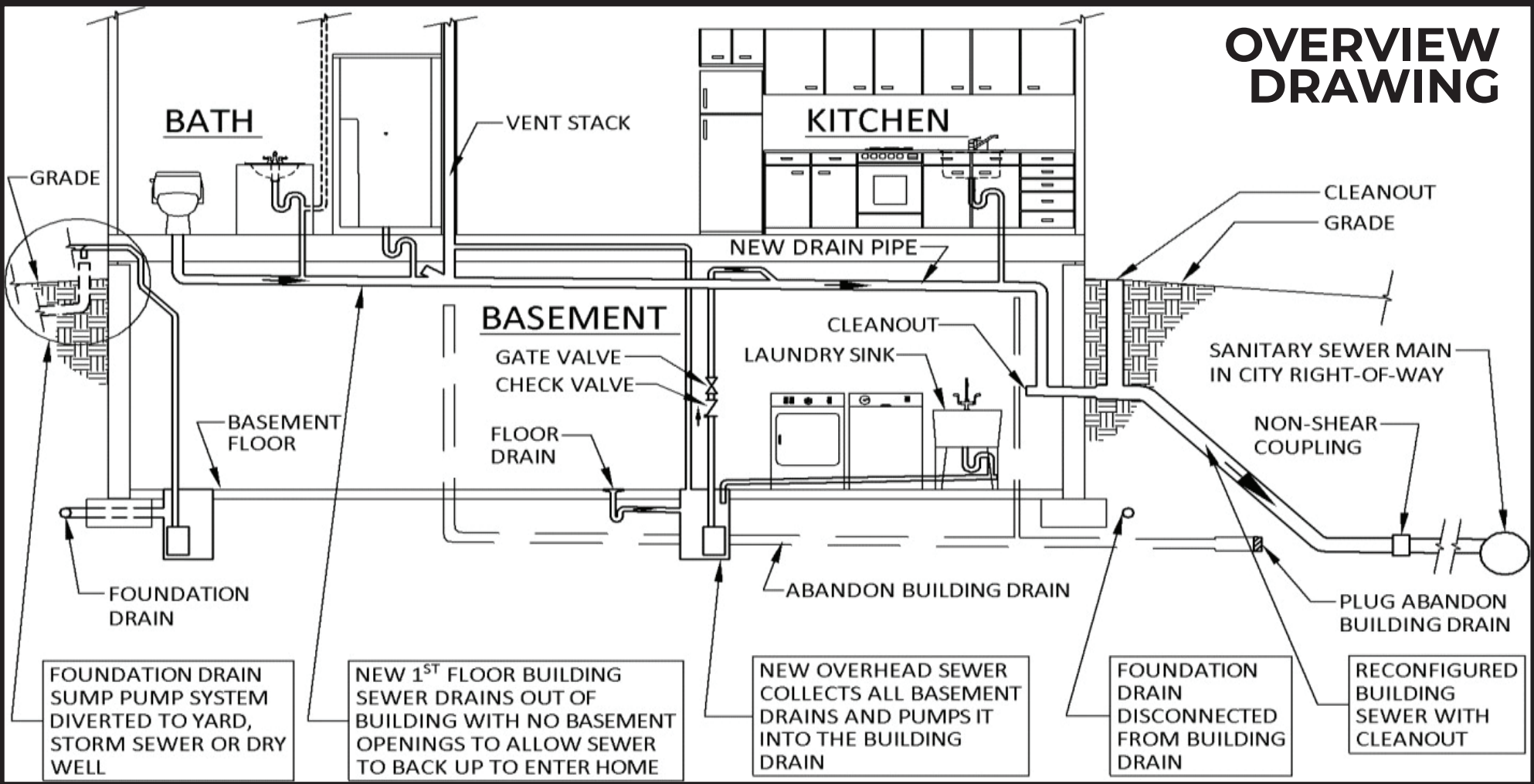

FOUNDATION DRAIN SUMP PUMP SYSTEM DIVERTED TO YARD, STORM SEWER OR DRY WELL

NEW 1<sup>ST</sup> FLOOR BUILDING SEWER DRAINS OUT OF BUILDING WITH NO BASEMENT OPENINGS TO ALLOW SEWER TO BACK UP TO ENTER HOME

NEW OVERHEAD SEWER COLLECTS ALL BASEMENT DRAINS AND PUMPS IT INTO THE BUILDING DRAIN

FOUNDATION DRAIN DISCONNECTED FROM BUILDING DRAIN

RECONFIGURED BUILDING SEWER WITH CLEANOUT